

Call: +44 (0)1276 685544



Cumberland Road, Camberley, Surrey, GU15 1SF

A four bedroom detached house presented in fantastic condition situated on a stunning large secluded plot set back along an 80ft driveway and within walking distance of sought after schools including Prior Heath, Heather Ridge and Ravenscote. The property has extensive scope for further extension subject to obtaining the necessary planning consents. Ground floor accommodation comprises living room, dining room, kitchen/breakfast room and utility room. On the first floor there are four well sized bedrooms including a fantastic master suite which has a dressing room with bespoke fitted furniture and refitted en suite shower room. There is also a family bathroom with bath and separate shower.

Price: £650,000

Overview

- Four Bedrooms
- Detached Home
- Large Private Plot
- Potential to Extend (STPP)
- Refitted Kitchen
- Utility Room
- Double Garage and Driveway
- Close to Sought After Schools
- EPC: TBC
- Freehold

Call: +44 (0)1276 685544



Call: +44 (0)1276 685544

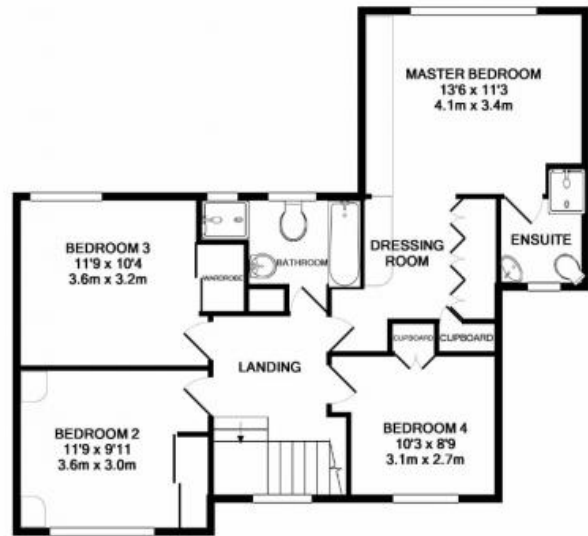
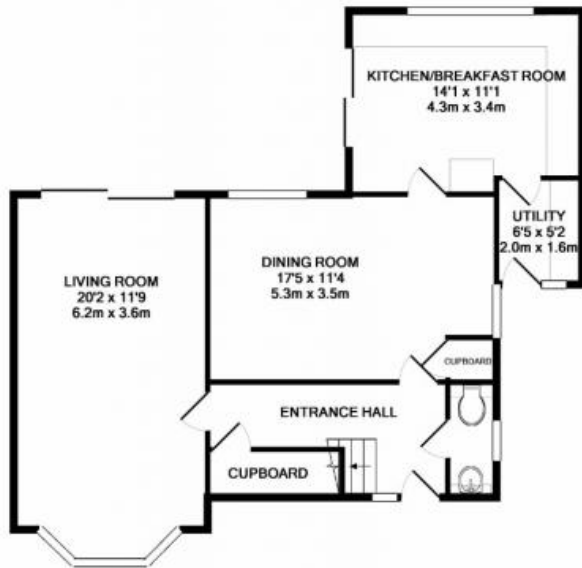

1ST FLOOR
APPROX. FLOOR
AREA 735 SQ.FT.
(68.2 SQ.M.)



GROUND FLOOR
APPROX. FLOOR
AREA 1072 SQ.FT.
(99.5 SQ.M.)

TOTAL APPROX. FLOOR AREA 1806 SQ.FT. (167.8 SQ.M.)

Whilst every attempt has been made to ensure the accuracy of the floor plan contained here, measurements of doors, windows, rooms and any other items are approximate and no responsibility is taken for any error, omission, or mis-statement. This plan is for illustrative purposes only and should be used as such by any prospective purchaser. The services, systems and appliances shown have not been tested and no guarantee as to their operability or efficiency can be given.
Made with Metropix 62019