

Call: +44 (0)1276 588100



## 8 Raleigh Way, Camberley, GU16 8RH

ORCHARD - Available Mid August. A well presented first floor apartment, situated within close proximity of Frimley Park Hospital and located in the Tomlinscote and Ravenscote School catchments. The accommodation comprises of two bedrooms, modern Shower Room, modern En-Suite Bathroom, modern Kitchen & spacious Lounge/Diner. Other benefits include gas central heating, communal parking, UPVC double glazing and a Juliet balcony. Unfurnished.

Price: £1,050 PCM

### Overview

- Available Mid August
- First Floor Apartment
- Two Double Bedrooms
- EPC RATING: C (76)
- Lounge/Diner
- Close Proximity To Frimley Park Hospital
- Radiator Heating
- Communal Off Road Parking
- Unfurnished

Call: +44 (0)1276 588100



Call: +44 (0)1276 588100

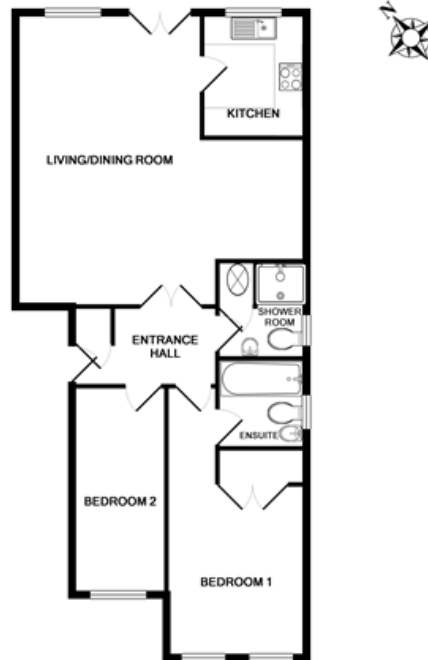

Whilst every attempt has been made to ensure the accuracy of the floor plan contained here, measurements of doors, windows, rooms and any other items are approximate and no responsibility is taken for any error, omission, or mis-statement. This plan is for illustrative purposes only and should be used as such by any prospective purchaser. The services, systems and appliances shown have not been tested and no guarantee as to their operability or efficiency can be given.  
Made with Metropix 62019